



Since 1915
Tucker
 W. L. TUCKER SUPPLY COMPANY, INC.
 "The Best Names In Construction Are Under Our Roof!"

2800 Second St.
 Cuyahoga Falls
 OH 44221

WWW.WLTUCKER.COM / CALL: 330.928.2155

04082/HOH
 BuyLine 1823

#NS Closed-Cell Neoprene Sponge

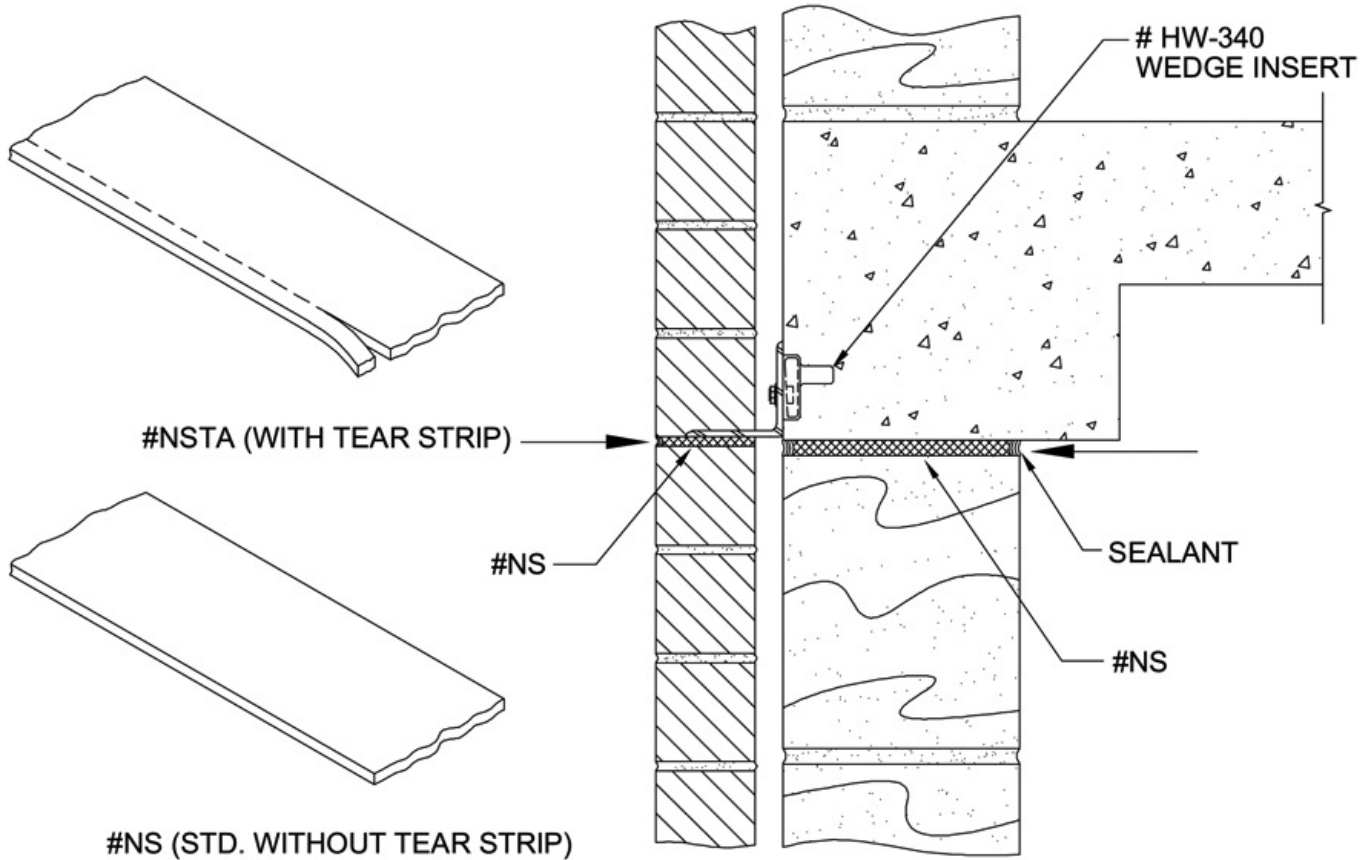

Summary Chart

Material	Thickness	Width
Closed Cell (ASTM D-1056 Grade 2A1)	<input type="checkbox"/> 1/4"	<input type="checkbox"/> 3"
<input type="checkbox"/> #NS - Without tear strip (standard)	<input type="checkbox"/> 3/8"	<input type="checkbox"/> 4"
<input type="checkbox"/> #NSTA - With tear strip	<input type="checkbox"/> 1/2"	<input type="checkbox"/> 6"
<input type="checkbox"/> Optional: Pressure - Sensitive adhesive on one side	<input type="checkbox"/> Other _____	<input type="checkbox"/> Other _____



Hohmann & Barnard, Inc.
 30 Rasons Court
 Hauppauge, New York 11788
 TEL: (800) 645-0616 FAX: (631) 234-0683

WEBSITE: www.h-b.com
 E-MAIL: weanchor@h-b.com

©HOHMANN & BARNARD, INC. - 1999