

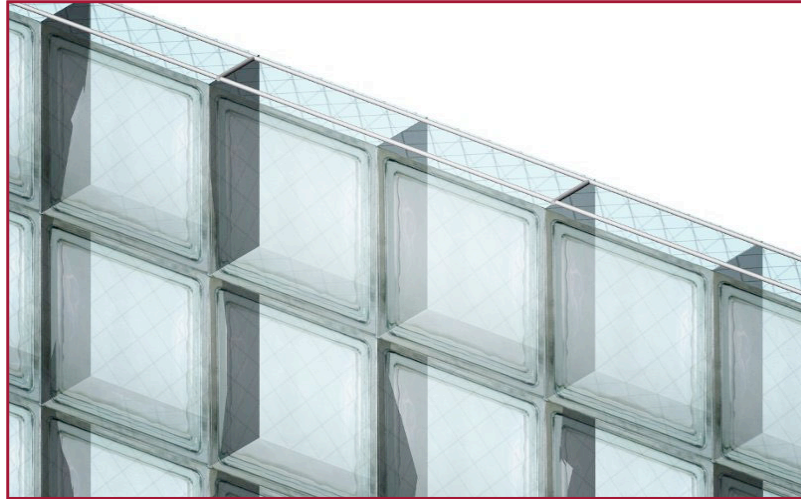



PRODUCT SUBMITTAL

Glass Block Reinforcing



MATERIAL CONFORMANCE	SIZES / FINISHES				
<p>ASTM A82 / A82M - (Cold drawn steel wire) Tensile Strength - 80,000 psi Yield Point - 70,000 psi</p> <p>ACI / ASCE 530 - (Building code requirements for masonry structures)</p> <p>SHEET METAL - (Carbon Steel) ASTM A1008 / A1008M</p> <p>Mill Galvanized / Zinc Coating: ASTM A641 / A641M (0.10 Oz per sq ft)</p> <p>Hot Dip Galvanized after fabrication / Zinc Coating ASTM A153 / A153M-B2 (1.50 oz per sq ft)</p> <p>Stainless Steel ASTM 580 / ASTM 580M Type 304 (Type 316 available on special order)</p> <table border="0" data-bbox="94 1606 738 1850"> <tr> <td>Steel Products (flats): Mill Galvanized & Hot Dip, 59.2% Post-Consumer 8.8% Post Industrial / Pre - Consumer</td> <td>WIRE Recycled Content: Mill Galvanized & Hot Dip, 85% Post-Consumer 13% Post Industrial / Pre - Consumer</td> </tr> <tr> <td>Stainless Steel, 60% Post Consumer V O C Content - 0%</td> <td>Stainless Steel, 60% Post Consumer V O C Content - 0%</td> </tr> </table>	Steel Products (flats): Mill Galvanized & Hot Dip, 59.2% Post-Consumer 8.8% Post Industrial / Pre - Consumer	WIRE Recycled Content: Mill Galvanized & Hot Dip, 85% Post-Consumer 13% Post Industrial / Pre - Consumer	Stainless Steel, 60% Post Consumer V O C Content - 0%	Stainless Steel, 60% Post Consumer V O C Content - 0%	<p>GLASS BLOCK REINFORCING: Manufactured to the same specifications as ladder type material except distance between longitudinal wire is 1-5/8" or 2". Continuous reinforcement ensures structurally sound glass block masonry</p> <p>FINISH: <input type="checkbox"/> Mill Galvanized <input type="checkbox"/> Hot Dip Galvanized <input type="checkbox"/> Stainless Steel </p> <p>PANEL ANCHOR: Provides support to standard glass block panels. Spaced and installed according to specification.</p> <p>DIMENSIONS: 20 gauge perforated strips, 1-3/4" x 24".</p> <p>FINISH: <input type="checkbox"/> Hot Dip Galvanized <input type="checkbox"/> Stainless Steel </p> <div data-bbox="1312 1703 1425 1812" style="text-align: right;">  </div>
Steel Products (flats): Mill Galvanized & Hot Dip, 59.2% Post-Consumer 8.8% Post Industrial / Pre - Consumer	WIRE Recycled Content: Mill Galvanized & Hot Dip, 85% Post-Consumer 13% Post Industrial / Pre - Consumer				
Stainless Steel, 60% Post Consumer V O C Content - 0%	Stainless Steel, 60% Post Consumer V O C Content - 0%				

Corporate Office: 400 Roundtree Rd Charlotte, NC 28217
 TEL: (800) 849-6722 FAX: (704) 525-3761

Mailing Address: P.O. Box 240988 Charlotte, NC 28224



www.wirebond.com

Memphis Plant: 2365 Harbor Ave. Memphis, TN 38113
 TEL: (800) 441-8359 FAX: (901) 775-9449

Mailing Address: P.O. Box 13124 Memphis, TN 38113