

BITUTHENE® 3000 AND BITUTHENE LOW TEMPERATURE

Self-adhesive, rubberized asphalt/polyethylene waterproofing membranes for basements and sub-structures

Description

Bituthene® 3000 and Bituthene Low Temperature are self-adhesive, rubberized asphalt/polyethylene waterproofing membranes used in basements and sub-structures.

Advantages

- **Waterproof**—high hydrostatic head resistance
- **Cross laminated film**—provides dimensional stability, high tear strength, puncture and impact resistance
- **Cold applied**—no flame hazard; self-adhesive overlaps ensure continuity
- **Chemically resistant**—provides effective external protection against aggressive soils and ground water
- **Flexible**—accommodates minor settlement and shrinkage movement
- **Controlled thickness**—factory made sheet ensures constant, non-variable site application
- **Wide application window**—
 - **Bituthene Low Temperature** surface and ambient temperatures between 25°F (-4°C) and 60°F (16°C)
 - **Bituthene 3000** surface and ambient temperatures at 40°F (5°C) or above

- **Ripcord® split release on demand**—faster application in the straight-aways, ease of membrane positioning in detailed areas

Use

Bituthene is ideal for waterproofing concrete, masonry and wood surfaces where in-service temperatures will not exceed 130°F (54°C). It can be applied to foundation walls, tunnels, earth sheltered structures and split slab construction, both above and below grade. (For above grade applications, see *Above Grade Waterproofing Bituthene 3000 and Bituthene Low Temperature*.)

Bituthene is 1/16 in. (1.5 mm) thick, 3 ft (0.9 m) wide and 66.7 ft (20 m) long and is supplied in rolls. It is unrolled sticky side down onto concrete slabs or applied onto vertical concrete faces primed with Bituthene Primer WP-3000, Primer B2 or Primer B2 LVC. Continuity is achieved by overlapping a minimum 2 in. (50 mm) and firmly rolling the joint.

Product Advantages

- Waterproof
- Cross laminated film
- Cold applied
- Chemically resistant
- Flexible
- Controlled thickness
- Wide application window
- Ripcord split release on demand

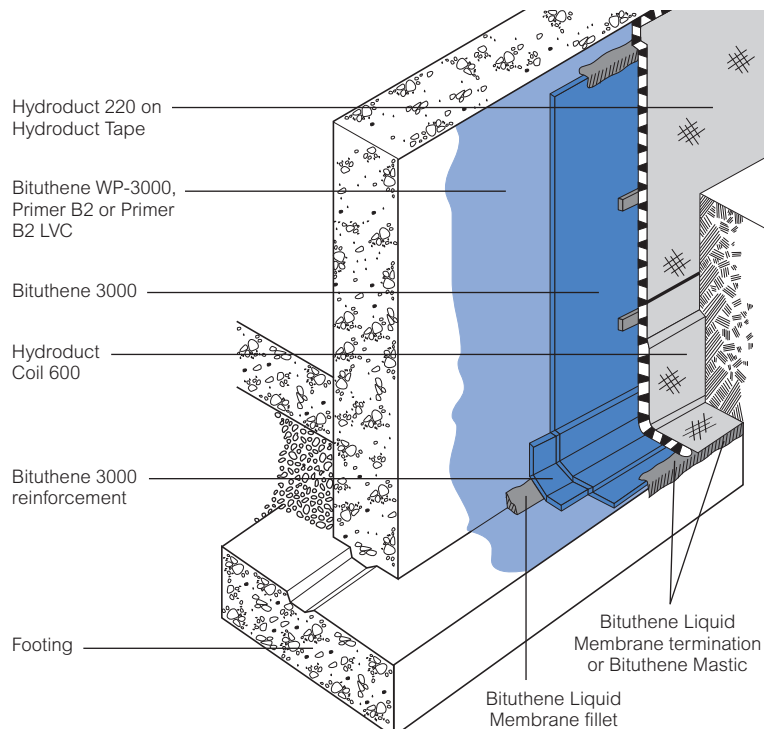

Drawings are for illustration purposes only.
Please refer to graceconstruction.com for specific application details.

Bituthene is extremely flexible. It is capable of bridging shrinkage cracks in the concrete and will accommodate minor differential movement throughout the service life of the structure.

Application Procedures

Safety, Storage and Handling Information

Bituthene products must be handled properly. Vapors from solvent-based primers and mastic are harmful and flammable. For these products, the best available information on safe handling, storage, personal protection, health and environmental considerations has been gathered. Material Safety Data Sheets (MSDS) are available at graceconstruction.com and users should acquaint themselves with this information. Carefully read detailed precaution statements on product labels and the MSDS before use.

Surface Preparation

Surfaces should be structurally sound and free of voids, spalled areas, loose aggregate and sharp protrusions. Remove contaminants such as grease, oil and wax from exposed surfaces. Remove dust, dirt, loose stone and debris. Concrete must be properly dried (minimum 7 days for normal structural concrete and 14 days for lightweight structural concrete).

If time is critical, Bituthene Primer B2 or Bituthene Primer B2 LVC may be used to allow priming and installation of membrane on damp surfaces or green concrete. Priming may begin in this case as soon as the concrete will maintain structural integrity. Use form release agents which will not transfer to the concrete. Remove forms as soon as possible from below horizontal slabs to prevent entrapment of excess moisture. Excess moisture may lead to blistering of the membrane. Cure concrete with clear, resin-based curing compounds which do not contain oil, wax or pigment. Except with Primer B2 or Primer B2 LVC, allow concrete to thoroughly dry following rain. Do not apply any products to frozen concrete.

Repair defects such as spalled or poorly consolidated areas. Remove sharp protrusions and form match lines. On masonry surfaces, apply a parge coat to rough concrete block and brick walls or trowel cut mortar joints flush to the face of the concrete blocks.

Temperature

- Apply Bituthene 3000 Membrane only in dry weather and at air and surface temperatures of 40°F (5°C) and above.
- Apply Bituthene Low Temperature Membrane only in dry weather and when air and surface temperatures are between 25°F (-4°C) and 60°F (16°C).
- Apply Bituthene Primer WP-3000 in dry weather above 40°F (5°C).

- Apply Bituthene Primer B2 in dry weather above 25°F (-4°C). (See separate product information sheet.)

Priming

- Apply Bituthene Primer WP-3000 by spray or roller at a coverage rate of 500–600 ft²/gal (12–15 m²/L). Allow to dry one hour or until concrete returns to original color.
- Apply Bituthene Primer B2 by a lamb's wool roller at a coverage rate of 250–350 ft²/gal (6–8 m²/L). Allow primer to dry one hour or until tack-free.
- Apply Bituthene Primer B2 LVC by a lamb's wool roller at a coverage rate of 325–425 ft²/gal (7.5–10 m²/L). Allow primer to dry one hour or until tack free.
- Dry time may be longer in cold temperatures. Reprime areas if contaminated by dust. If the work area is dusty, apply membrane as soon as the primer is dry.
- **Do not apply any primer to Bituthene membrane.**

Corner Details

The treatment of corners varies depending on the location of the corner. For detailed information on Bituthene Liquid Membrane, see separate product information sheet.

- At wall to footing inside corners—
Option 1: Apply membrane to within 1 in. (25 mm) of base of wall. Treat the inside corner by installing a ¾ in. (20 mm) fillet of Bituthene Liquid Membrane. Extend Bituthene Liquid Membrane at least 2½ in. (65 mm) onto footing, and 2½ in. (65 mm) onto wall membrane.
Option 2: Treat the inside corner by installing a ¾ in. (20 mm) fillet of Bituthene Liquid Membrane. Apply 12 in. (300 mm) wide strip of sheet membrane centered over fillet. Apply wall membrane over inside corner and extend 6 in. (150 mm) onto footing. Apply 1 in. (25 mm) wide troweling of Bituthene Liquid Membrane over all terminations and seams within 12 in. (300 mm) of corner.
- At footings where the elevation of the floor slab is 6 in. (150 mm) or more above the footing, treat the inside corner either by the above two methods or terminate the membrane at the base of the wall. Seal the termination with Bituthene Liquid Membrane.

Joints

Properly seal all joints with waterstop, joint filler and sealant as required. Bituthene membranes are not intended to function as the primary joint seal. Allow sealants to fully cure. Pre-strip all slab and wall cracks over ¼ in. (1.5 mm) wide and all construction and control joints with 9 in. (230 mm) wide sheet membrane strip.

Application on Horizontal Surfaces

(Note: Preprufe® pre-applied membranes are strongly recommended for below slab or for any application where the membrane is applied before concreting. See Preprufe product information sheets.)

Apply membrane from the low point to the high point so that laps shed water. Overlap all seams at least 2 in. (50 mm). Stagger all end laps. Roll the entire membrane firmly and completely as soon as possible. Use a linoleum roller or standard water-filled garden roller less than 30 in. (760 mm) wide, weighing a minimum of 75 lbs (34 kg) when filled. Cover the face of the roller with a resilient material such as a ½ in. (13 mm) plastic foam or two wraps of indoor-outdoor carpet to allow the membrane to fully contact the primed substrate. Seal all T-joints and membrane terminations with Bituthene Liquid Membrane at the end of the day.

Protrusions and Drains

Apply membrane to within 1 in. (25 mm) of the base of the protrusion. Apply Bituthene Liquid Membrane 0.1 in. (2.5 mm) thick around protrusion. Bituthene Liquid Membrane should extend over the membrane a minimum of 2½ in. (65 mm) and up the penetration to just below the finished height of the wearing course.

Vertical Surfaces

Apply membrane in lengths up to 8 ft (2.5 m). Overlap all seams at least 2 in. (50 mm). On higher walls apply membrane in two or more sections with the upper overlapping the lower by at least 2 in. (50 mm). Roll all membrane with a hand roller.

Terminate the membrane at grade level. Press the membrane firmly to the wall with the butt end of a hardwood tool such as a hammer handle or secure into a reglet. Failure to use heavy pressure at terminations can result in a poor seal. A termination bar may be used to ensure a tight seal. Terminate the membrane at the base of the wall if the bottom of the interior floor slab is at least 6 in. (150 mm) above the footing. Otherwise, use appropriate inside corner detail where the wall and footing meet.

Membrane Repairs

Patch tears and inadequately lapped seams with membrane. Clean membrane with a damp cloth and dry. Slit fishmouths and repair with a patch extending 6 in. (150 mm) in all directions from the slit and seal edges of the patch with Bituthene Liquid Membrane. Inspect the membrane thoroughly before covering and make any repairs.

Drainage

Hydroduct® drainage composites are recommended for both active drainage and protection of the membrane. See Hydroduct product information sheets.

Protection of Membrane

Protect Bituthene membranes to avoid damage from other trades, construction materials or backfill. Place protection immediately in temperatures above 77°F (25°C) to avoid potential for blisters.

- On vertical applications, use Hydroduct 220 Drainage Composite. Adhere Hydroduct 220 Drainage Composite to membrane with Hydroduct Tape. Alternative methods of protection are to use ¼ in. (6 mm) asphalt impregnated board or 1 in. (25 mm) extruded polystyrene. Such alternatives do not provide positive drainage to the system. Adhere protection board with an adhesive or Hydroduct Tape.
- In mud slab waterproofing, or other applications where positive drainage is not desired and where reinforced concrete slabs are placed over the membrane, the use of ¼ in. (6 mm) hardboard or 2 layers of ⅛ in. (3 mm) hardboard is recommended.

Insulation

Always apply Bituthene membrane directly to primed or conditioned structural substrates. Insulation, if used, must be applied over the membrane. Do not apply Bituthene membranes over lightweight insulating concrete.

Backfill

Place backfill as soon as possible. Use care during backfill operation to avoid damage to the waterproofing system. Follow generally accepted practices for backfilling and compaction. Backfill should be added and compacted in 6 in. (150 mm) to 12 in. (300 mm) lifts.

For areas which cannot be fully compacted, a termination bar is recommended across the top termination of the membrane.

Placing Steel

When placing steel over properly protected membrane, use concrete bar supports (dobies) or chairs with plastic tips or rolled feet to prevent damage from sharp edges. Use special care when using wire mesh, especially if the mesh is curled.

Approvals

- City of Los Angeles Research Report RR 24386
- U.S. Department of Housing and Urban Development (HUD) HUD Materials Release 628E

Warranty

Five year material warranties covering Bituthene and Hydroduct products are available upon request. Contact your Grace sales representative for details.

Technical Services

Support is provided by full time, technically trained Grace representatives and technical service personnel, backed by a central research and development staff.

Supply

Bituthene 3000 or Bituthene Low Temperature	3 ft x 66.7 ft roll (200 ft ²) [0.9 m x 20 m (18.6 m ²)]
Roll weight	83 lbs (38 kg) gross
Palletization	25 rolls per pallet
Storage	Store upright in dry conditions below 95°F (+35°C).
Ancillary Products	
Bituthene WP-3000	5 gal (18.9 L) pail/24 pails per pallet
Bituthene Primer B2	5 gal (18.9 L) pail/48 pails per pallet
Bituthene Primer B2 LVC	5 gal (18.9 L) pail/48 pails per pallet
Bituthene Liquid Membrane	1.5 gal (5.7 L) pail/100 pails per pallet or 4 gal (15.1 L) pail/24 pails per pallet
Hydroduct Tape	1 in. x 200 ft (2.5 cm x 61.0 m) roll/6 rolls per carton
Bituthene Mastic	Twelve 30 oz (0.9 L) tubes/carton or 5 gal (18.9 L) pail/36 pails per pallet

Equipment by others: Soft broom, utility knife, brush or roller for priming

Physical Properties for Bituthene Membrane

Property	Typical Value	Test Method
Color	Dark gray-black	
Thickness	1/16 in. (1.5 mm) nominal	ASTM D3767—method A
Flexibility, 180° bend over 1 in. (25 mm) mandrel at -25°F (-32°C)	Unaffected	ASTM D1970
Tensile strength, membrane, die C	325 lbs/in. ² (2240 kPa) minimum	ASTM D412 modified ¹
Tensile strength, film	5,000 lbs/in. ² (34.5 MPa) minimum	ASTM D882 modified ¹
Elongation, ultimate failure of rubberized asphalt	300% minimum	ASTM D412 modified ¹
Crack cycling at -25°F (-32°C), 100 cycles	Unaffected	ASTM C836
Lap adhesion at minimum application temperature	3000: 4 lbs/in. (700 N/m) Low Temp: 5 lbs/in. (880 N/m)	ASTM D1876 modified ²
Peel strength	9 lbs/in. (1576 N/m)	ASTM D903 modified ³
Puncture resistance, membrane	50 lbs (222 N) minimum	ASTM E154
Resistance to hydrostatic head	200 ft (60 m) of water	ASTM D5385
Permeance	0.05 perms (2.9 ng/m ² sPa) maximum	ASTM E96, section 12—water method
Water absorption	0.1% maximum	ASTM D570

Footnotes:

1. The test is run at a rate of 2 in. (50 mm) per minute.
2. The test is conducted 15 minutes after the lap is formed and run at a rate of 2 in. (50 mm) per minute at 40°F (5°C).
3. The 180° peel strength is run at a rate of 12 in. (300 mm) per minute.



Since 1915

Tucker

W. L. TUCKER SUPPLY COMPANY, INC.

"The Best Names In Construction Are Under Our Roof!"

2800 Second St.
Cuyahoga Falls
OH 44221

WWW.WLTUCKER.COM

CALL: 330.928.2155

www.graceconstruction.com

For technical assistance call toll free at 866-333-3SBM (3726)

Bituthene, Preprufe, Ripcord and Hydroduct are registered trademarks of W. R. Grace & Co.—Conn.

We hope the information here will be helpful. It is based on data and knowledge considered to be true and accurate and is offered for the users' consideration, investigation and verification, but we do not warrant the results to be obtained. Please read all statements, recommendations or suggestions in conjunction with our conditions of sale, which apply to all goods supplied by us. No statement, recommendation or suggestion is intended for any use which would infringe any patent or copyright. W. R. Grace & Co.—Conn., 62 Whittemore Avenue, Cambridge, MA 02140. In Canada, Grace Canada, Inc., 294 Clements Road, West, Ajax, Ontario, Canada L1S 3C6.

This product may be covered by patents or patents pending.
BIT-210F Printed in U.S.A. 9/08

Copyright 2007. W. R. Grace & Co.—Conn.
FA/LVI/1M

GRACE